

NORTH CAROLINA DEPARTMENT OF TRANSPORTATION

PROPOSED ROADSIDE ENVIRONMENTAL LANDSCAPE DESIGN & AESTHETICS PROJECT

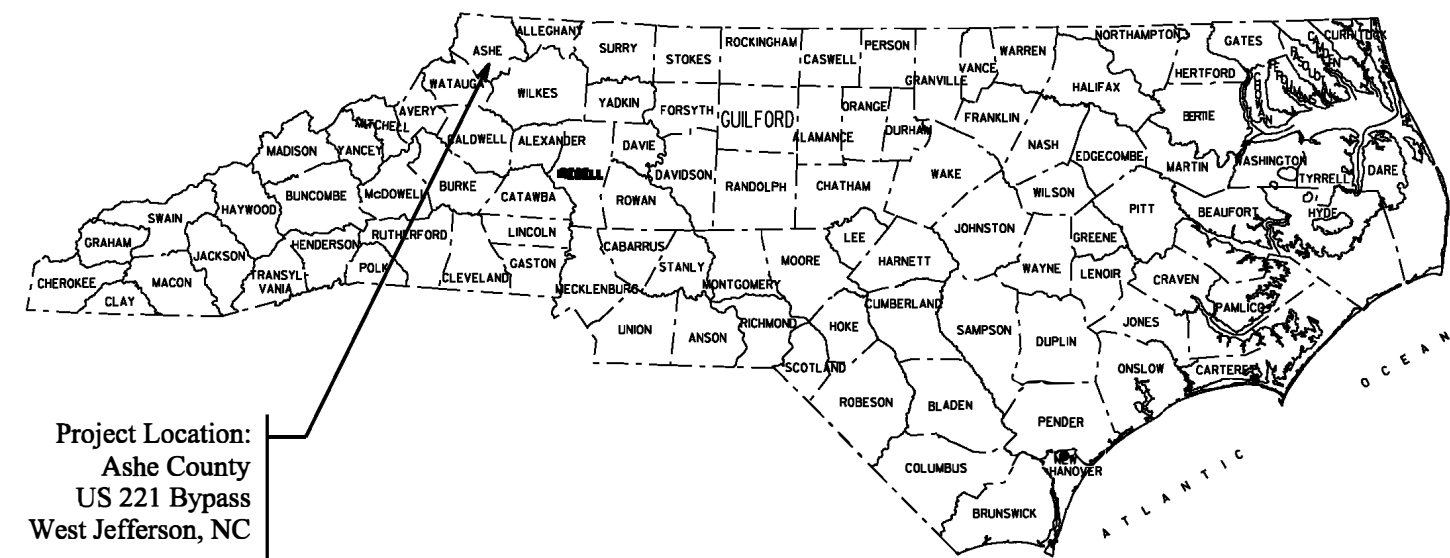

Project Location:
Ashe County
US 221 Bypass
West Jefferson, NC

CONVENTIONAL SYMBOLS

County Line	---
City or Town Line	---
Exist. Right of Way Line Marker	—▲—
Prop. Right of Way Line Marker (By Others)	—▲—
Prop Right of Way Line Marker (By Contract)	—▲—
Exist. Control of Access Line	—(X)—
Prop. Control of Access Line	—(X)—
Property Line	—E—
Easement Line	—E—
Slope Stake Line	—+—
Exist. Fence	—+—
Prop. Woven Wire Fence	—+—
Prop. Chain Link Fence	—+—
Exist. Road	—+—
Prop. Road	—+—
Guardrail	—+—
Survey Line	—+—
Denotes Line Equality	—+—
Bridge	—+—
Culvert	—+—
Railroad	—+—
Woods	—+—
Exist. Telephone Pole	—+—
Prop. Telephone Pole	—+—
Tower Pole and Line	—+—
Exist. Power Pole	—+—
Prop. Power Pole	—+—
Sanitary Sewer Line	—+—
Water Line	—+—
Gas Line	—+—
Picnic Shelter	—+—
Regeneration	—+—
Reforestation	—+—
Large Deciduous Tree	—+—
Evergreen Tree	—+—
Small or Flowering Tree	—+—
Shrubs	—+—
Planting Bed	—+—

Summary of Quantities

QUANTITY	UNIT	KEY	BOTANICAL NAME	COMMON NAME	FURNISH	
Evergreen Trees (LARGE)						
36	EA	PAL	<i>Picea abies</i>	Frasier Fir	6-8', B&B, Specimen 3.1.2.4	As Shown
Deciduous Trees (LARGE)						
12	EA	ABL	<i>Acer rubrum</i> 'Autumn Blaze'	Autumn Blaze Red Maple	2-2 1/2" Cal., 12-14', B&B, Specimen	As Shown
7	EA	ARL	<i>Acer rubrum</i> 'October Glory'	October Glory Red Maple	2-2 1/2" Cal., 12-14', B&B, Specimen	As Shown
3	EA	QAL	<i>Quercus alba</i>	White Oak	2-2 1/2" Cal., 12-14', B&B, Specimen	As Shown
3	EA	QCL	<i>Quercus coccinea</i>	Scarlet Oak	2-2 1/2" Cal., 12-14', B&B, Specimen	As Shown
6	EA	QSL	<i>Quercus shumardii</i>	Shumard Oak	2-2 1/2" Cal., 12-14', B&B, Specimen	As Shown
13	EA	TGL			8-10', B&B, Specimen	As Shown
Shrubs / Native Grass and Perennial Varieties						
1640	EA	BA	<i>Bouteloua gracilis</i> 'Blonde Ambition' PP22048	Blue Grama Grass	#1 Cont.	2' O.C.
850	EA	HB	<i>Hemerocallis</i> 'Buttered Popcorn'	Buttered Popcorn Daylily	Single Fan Rhizome	2' O.C.
115	EA	IC	<i>Iris</i> 'Caesars's Brother'	Caesars's Brother Bearded Iris	Single Fan Rhizome	24" O.C.
1045	EA	ND	<i>Narcissus</i> 'Dutch Master'	Dutch Master Daffodil	DN II	24" O.C.
377	EA	PV	<i>Panicum virgatum</i> 'Cloud Nine'	Cloud Nine Switchgrass	#1 Cont.	5' O.C.
700	EA	RF	<i>Rudbeckia fulgida</i> 'Goldstrum'	Black Eyed Susan	#1 Cont.	2' O.C.
Descriptions						
18	EA	SP		Establishment		
400	CY	1670		Mulch for Planting		
2700	SY	1670		Post-Emergence Herbicidal Treatment for Plant Beds		
2700	SY	1660		Pre-Emergence Plant Bed Herbicide Treatment		
3	ACRE	SP		Supplemental Seeding & Repairing		
100	M/G	1670		Water for Planting		
250	M/G	1670		Water for Sod		
1970	SY	SP		Sod		
10	Cycles	SP		Specialty Mowing		
1	Lump Sum	SP		Traffic Control		

T.I.P. #	STATE PROJECT #	SHEET #	SHEET #
R2915 D	34518.3.FR4	L1A	6
FED. PROJ. #	DESCRIPTION	DIVISION	
00000.000.000	US 221 WEST JEFFERSON	11	

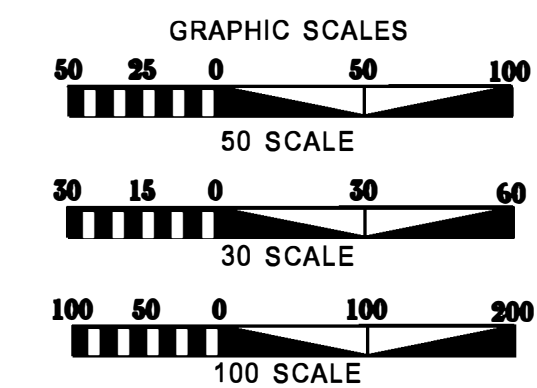

Designed By: Jeff Lackey 6/2021

REVISIONS

DATE	DESCRIPTION

INDEX OF (L) SHEETS:

- L1A - TITLE SHEET
- L1B - PLANTING DETAILS
- L1C - SHEET LAYOUT PLAN / SYMBOLOGY

SHEET LAYOUT PLANS -

- L2 - LANDSCAPE PLANTING PLAN
- L3 - LANDSCAPE PLANTING PLAN
- L4 - LANDSCAPE PLANTING PLAN

STATE OF
NORTH CAROLINA
DEPARTMENT OF TRANSPORTATION

LOCATION: US 221 FROM SOUTH OF NC 194 TO US 221 BYPASS

TYPE OF WORK: ENHANCED Corridor Enhancement Design & Development

COUNTY: ASHE COUNTY

2018 STANDARD SPECIFICATIONS

PREPARED IN THE OFFICE OF:
NCDOT- ROADSIDE ENVIRONMENTAL UNIT
DESIGN & DEVELOPMENT SECTION
1557 MAIL SERVICE CENTER
RALEIGH NC 27699 919-707-2920

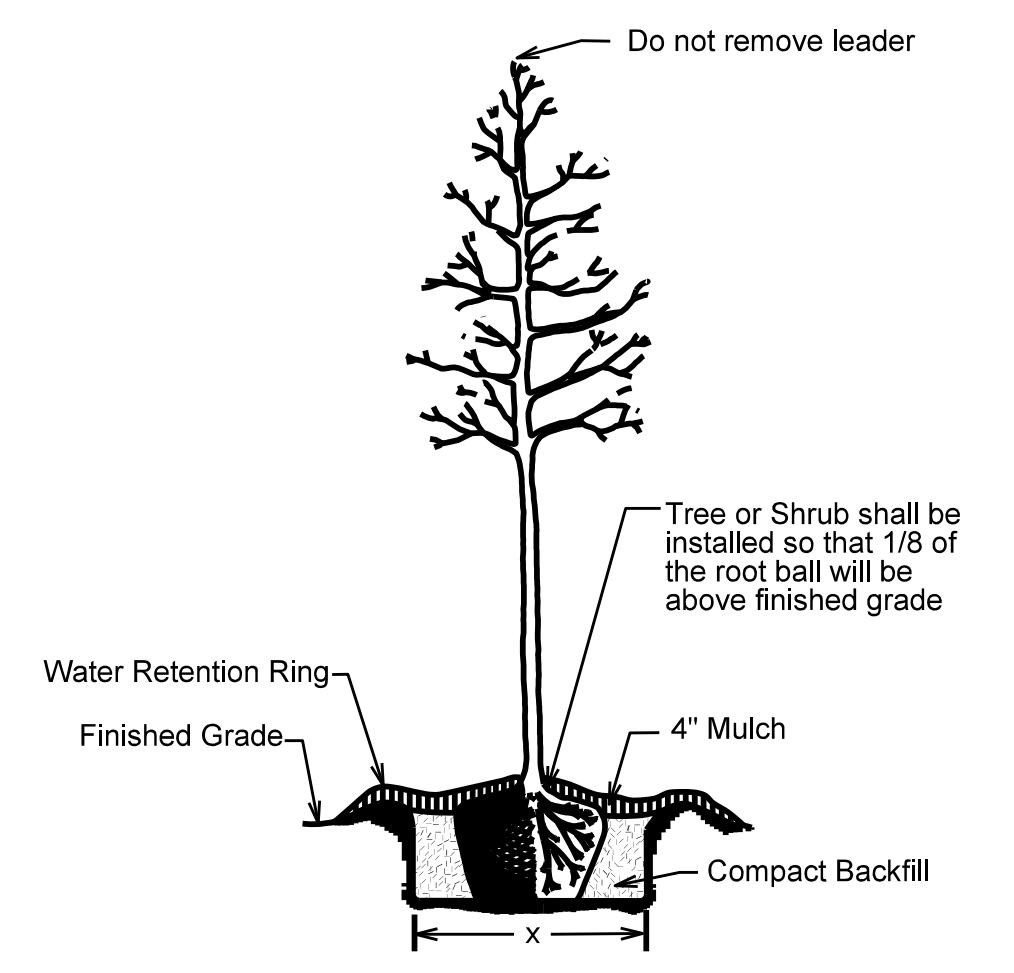
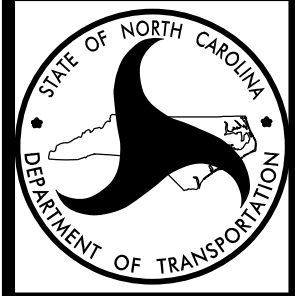

TREE OR SHRUB PLANTING DETAIL
(LEVEL GROUND)

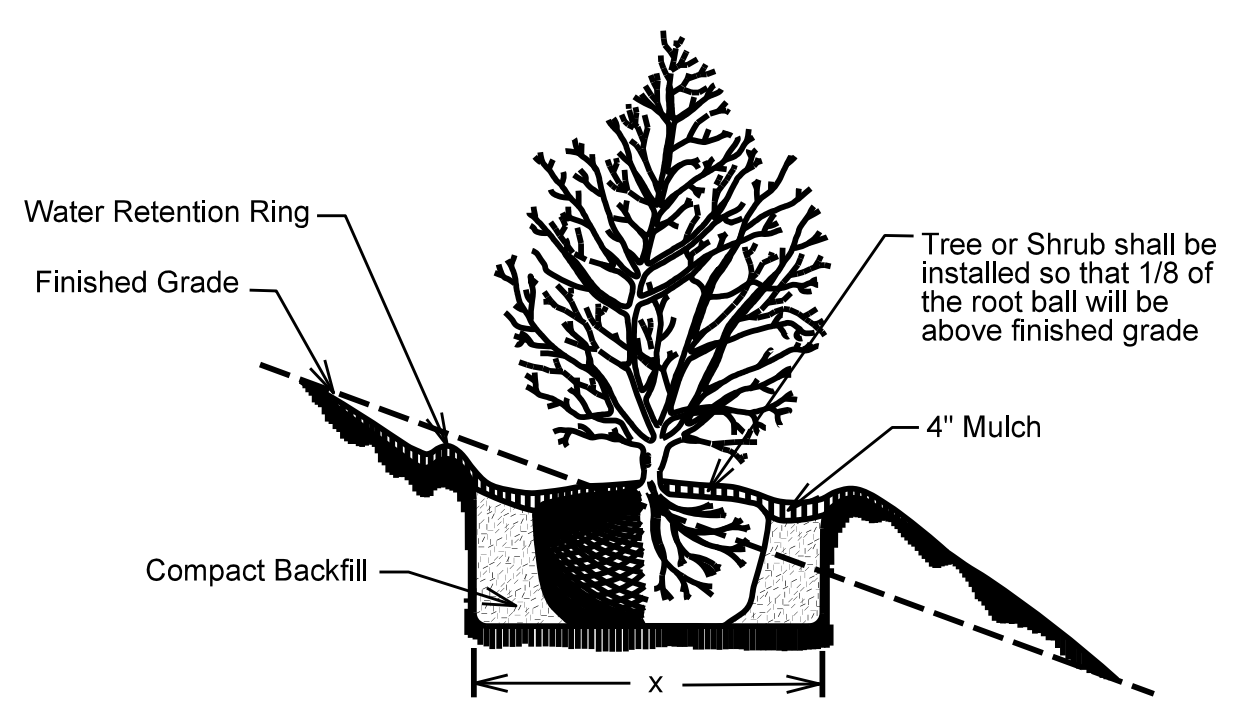

TREE OR SHRUB PLANTING DETAIL
(SLOPING GROUND)

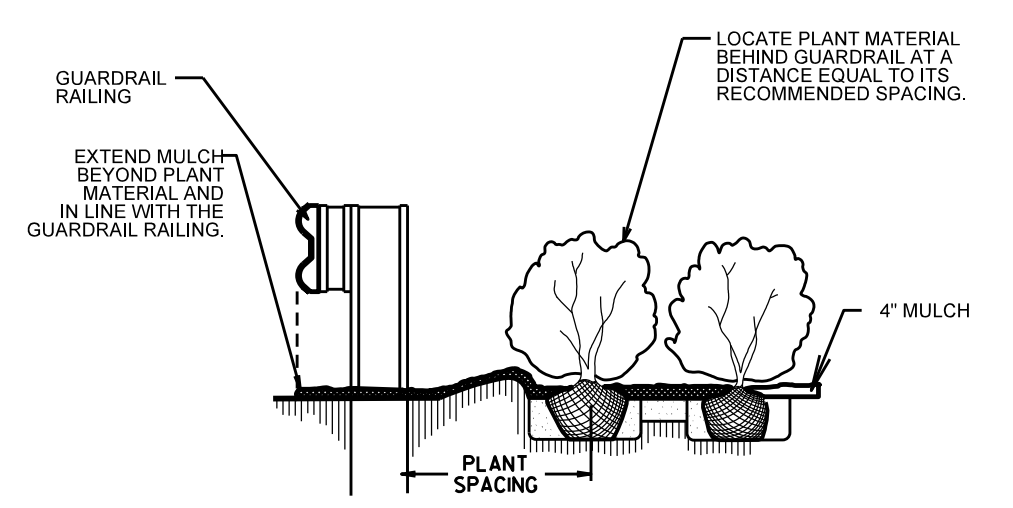

GUARDRAIL MULCHING DETAIL
* Detail to be used when approved by the Engineer.

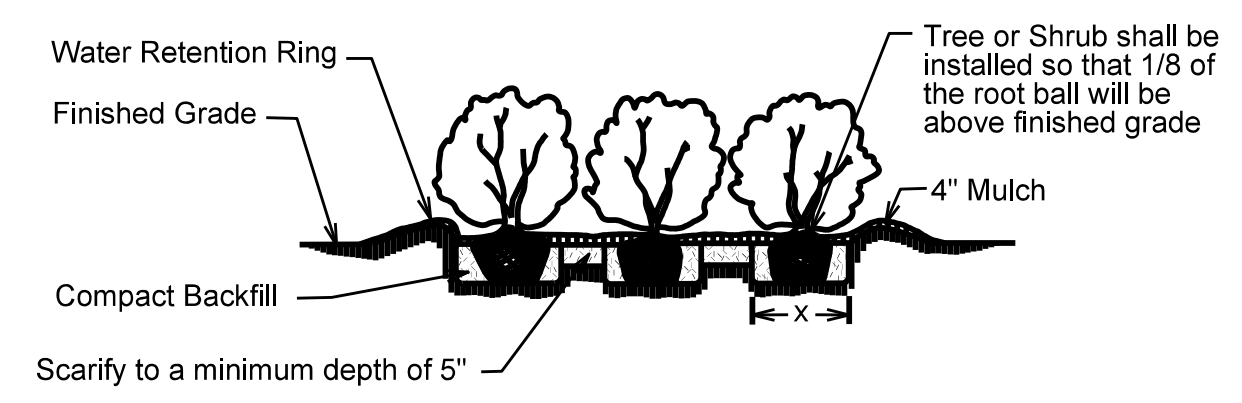

Shrub Bed Planting Detail

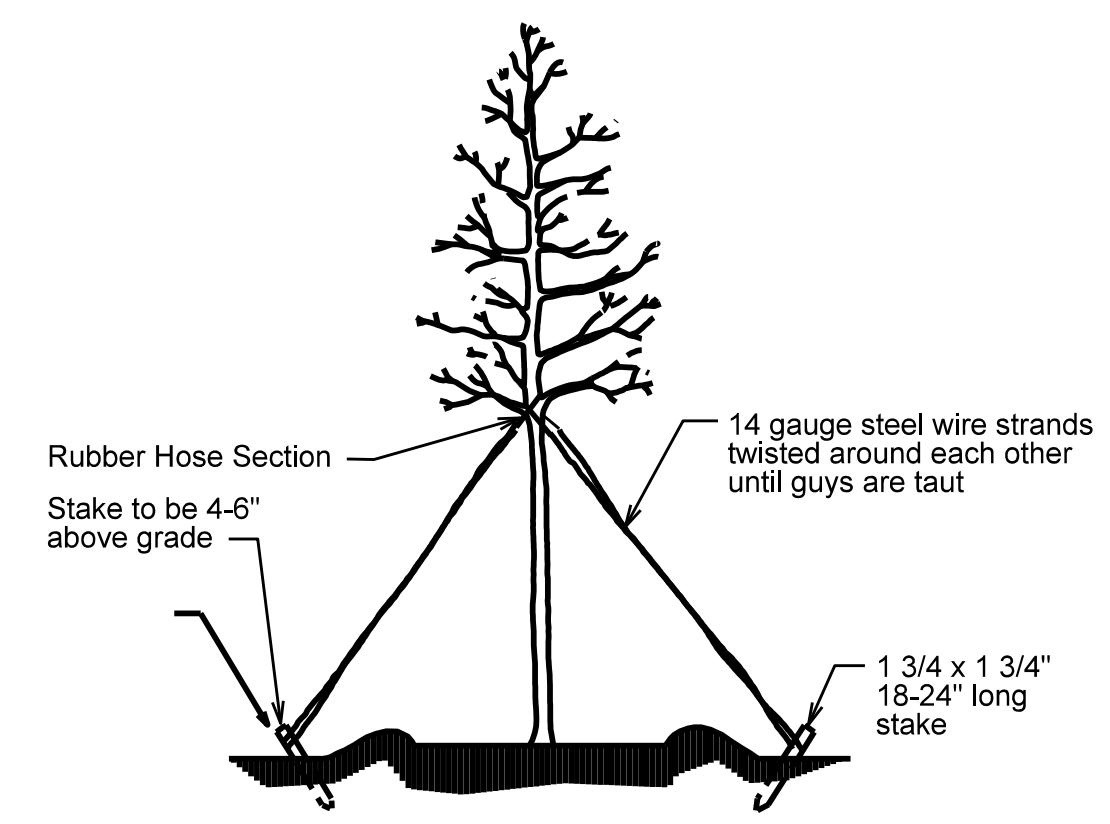

TREE GUYING DETAIL
(FOR TREES 10' OR LARGER)
* Utilize guying detail only if requested by the Engineer.

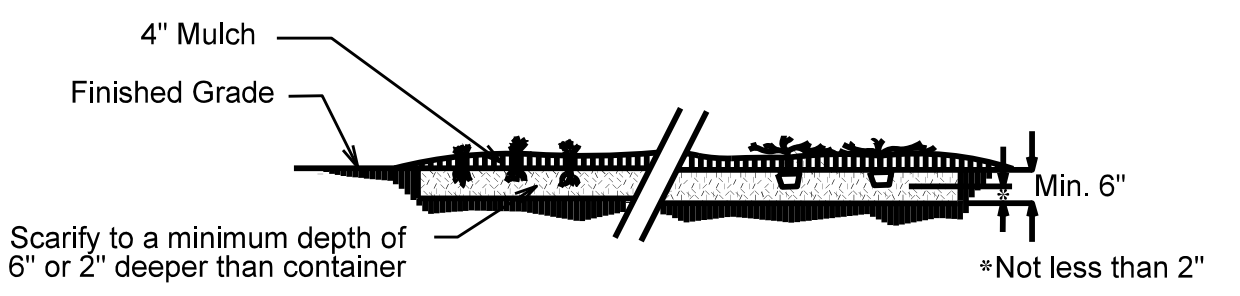

*Plants may be planted before or after mulching operation
Groundcover Planting Detail

NOTES:

SCHEDULE FOR PLANT HOLE SIZE:
CONTAINER OR ROOT BALL SIZE
X = 2 TIMES THE DIAMETER OF THE CONTAINER OR THE ROOT BALL DIAMETER

FERTILIZER SHALL BE APPLIED AT TIME OF PLANTING. FERTILIZER SHALL BE A SLOW RELEASE PELLET OR TABLET. FORMULATION SHALL BE APPROVED BY ENGINEER IN THE FIELD.

RATES SHALL BE PER MANUFACTURERS RECOMMENDATIONS AND APPROVED BY THE ENGINEER IN THE FIELD. THOROUGHLY MIX WITH TOPSOIL, BACKFILL OR SCARIFIED SOIL.

REMOVE BURLAP FROM TOP OF BALL BEFORE BACKFILLING AROUND BALL IS COMPLETE

SEE STANDARD SPECIFICATIONS FOR PLANT BED HERBICIDE TREATMENT

When mulched bed is adjacent to guard rail run mulch to front edge of guard rail - see detail

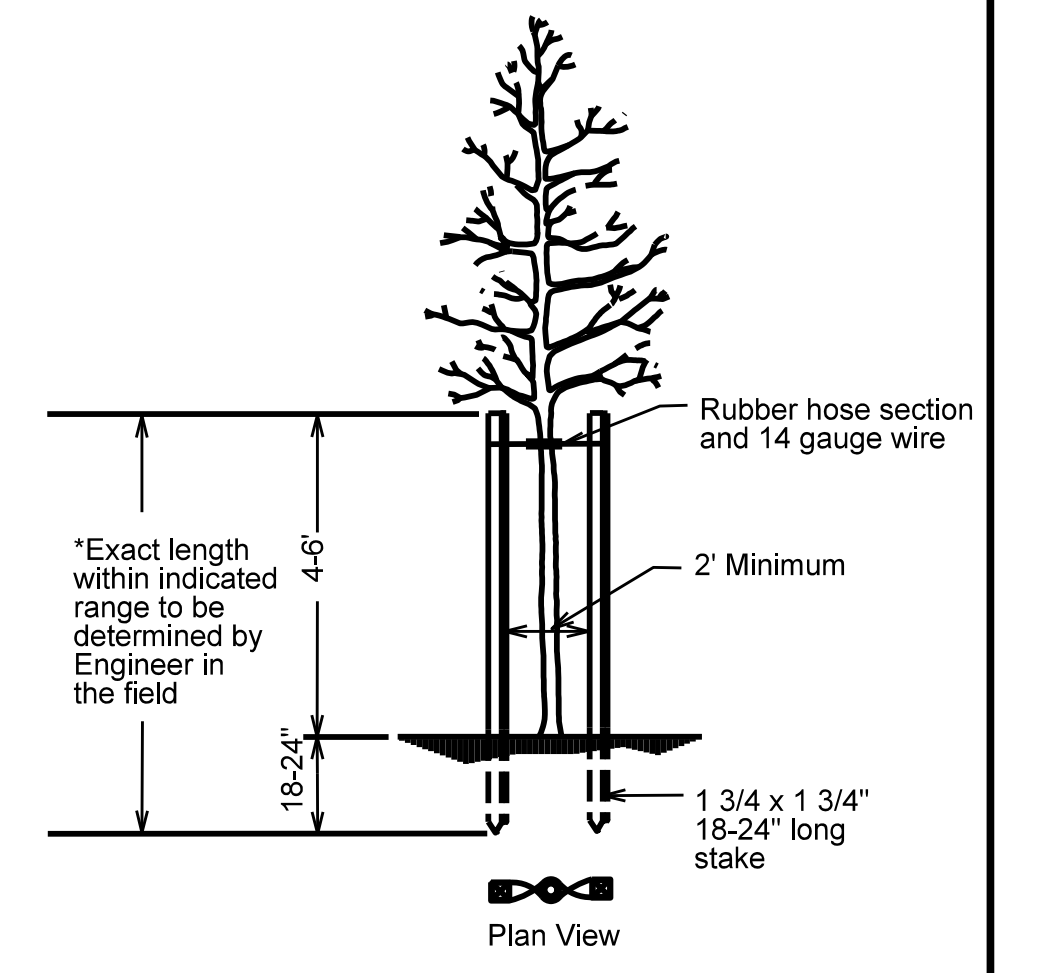
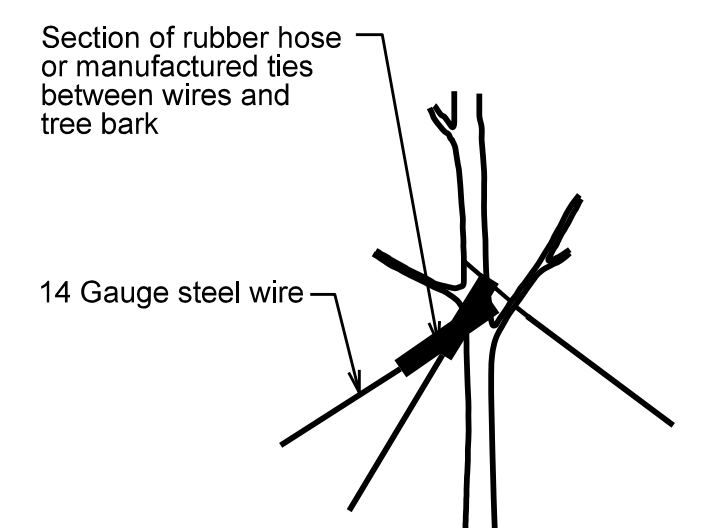
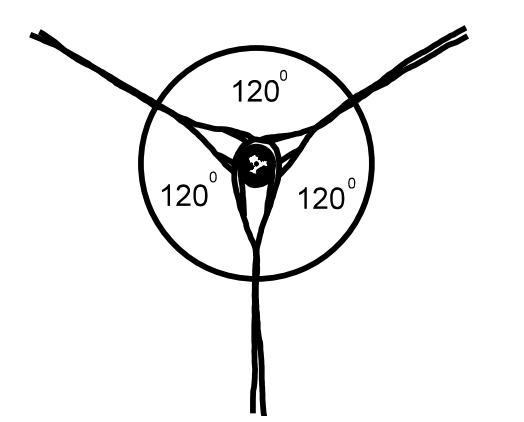
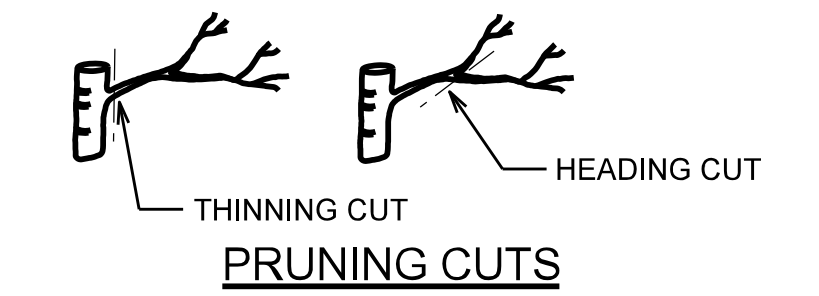

Align Grasses around the edge of plant bed to establish GRID. Start center of grasses & perennials half the spacing distance from edge of plant bed

Establish the O.C. Grid for Grasses & Perennials. See Plant List for individual spacing.

Typical Plan View @ Layout for Native Grass & Perennial Plantings
No Scale

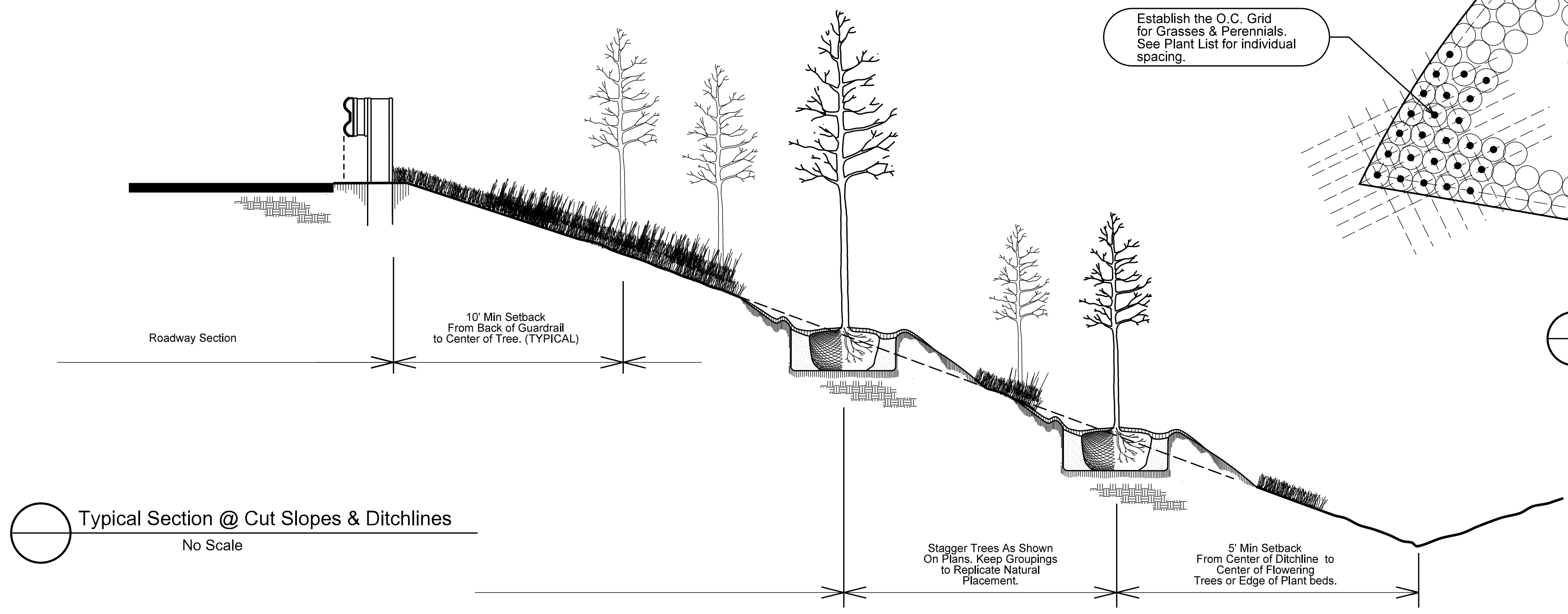

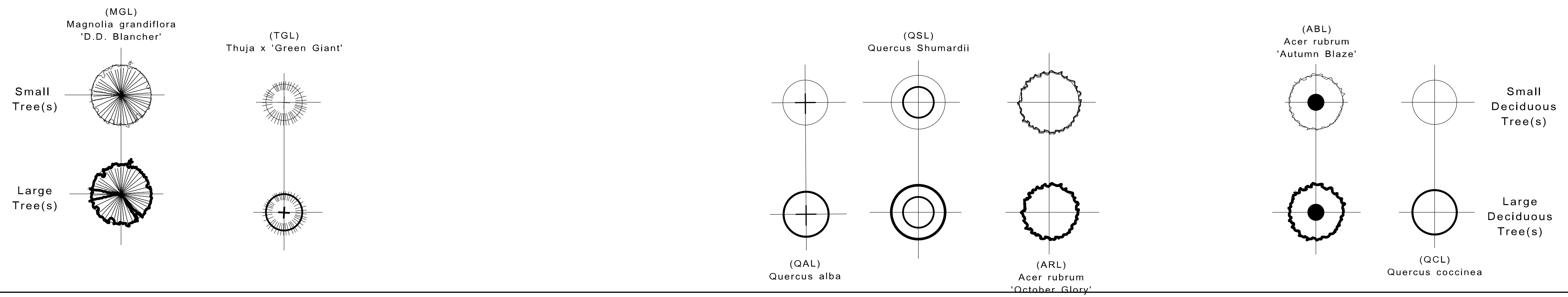
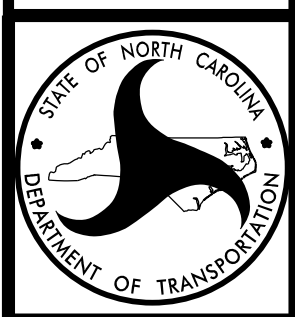

PLANT SYMBOLOLOGY (Tree Cultivars)

Notes:

- Contractor Shall Consult with Engineers Prior to any field adjustments. Follow plans as close as possible. Bed layouts should be adjusted to incorporate existing traffic signage, utilities, where necessary, and any sight distance issues that may develop -especially at the medians. Ensure caution is maintained during stakeout to maintain clear site lines. Details may be adjusted to accommodate site. Spacing may be decreased to fit material at specified locations. Consult with Engineer to ensure proper development.

- Contractor shall utilize all NCDOT Standard Specifications for all line items listed. These shall be utilized in conjunction with the Special Provisions. Consult with Engineer in the field to maintain accuracy.

- Mowing shall take place along all sodded and supplemental seeded areas, repair and supplemental seeding are labeled on plans-SEE PLANS. Note-the seeding and mulching special provisions outline mowing height and other important information. Those areas where trees are to be incorporated shall be mowed out initially and maintained as directed by the NCDOT Specs. Consult with Architect & Engineer in the field. All Native Grass, Perennials Plantings shall be installed as a continuous mulched bed and shall be treated with Post- Emergence treatment. The individual trees shall be treated with Post Emergence and mulched individually as shown on the plans.

- Trees to be field staked by the REU ENGINEER. Consult with Engineer for more detailed information to ensure the plants are located according to NCDOT Standard Specifications and are in no conflict with existing utilities, existing vegetation and possible sight lines.

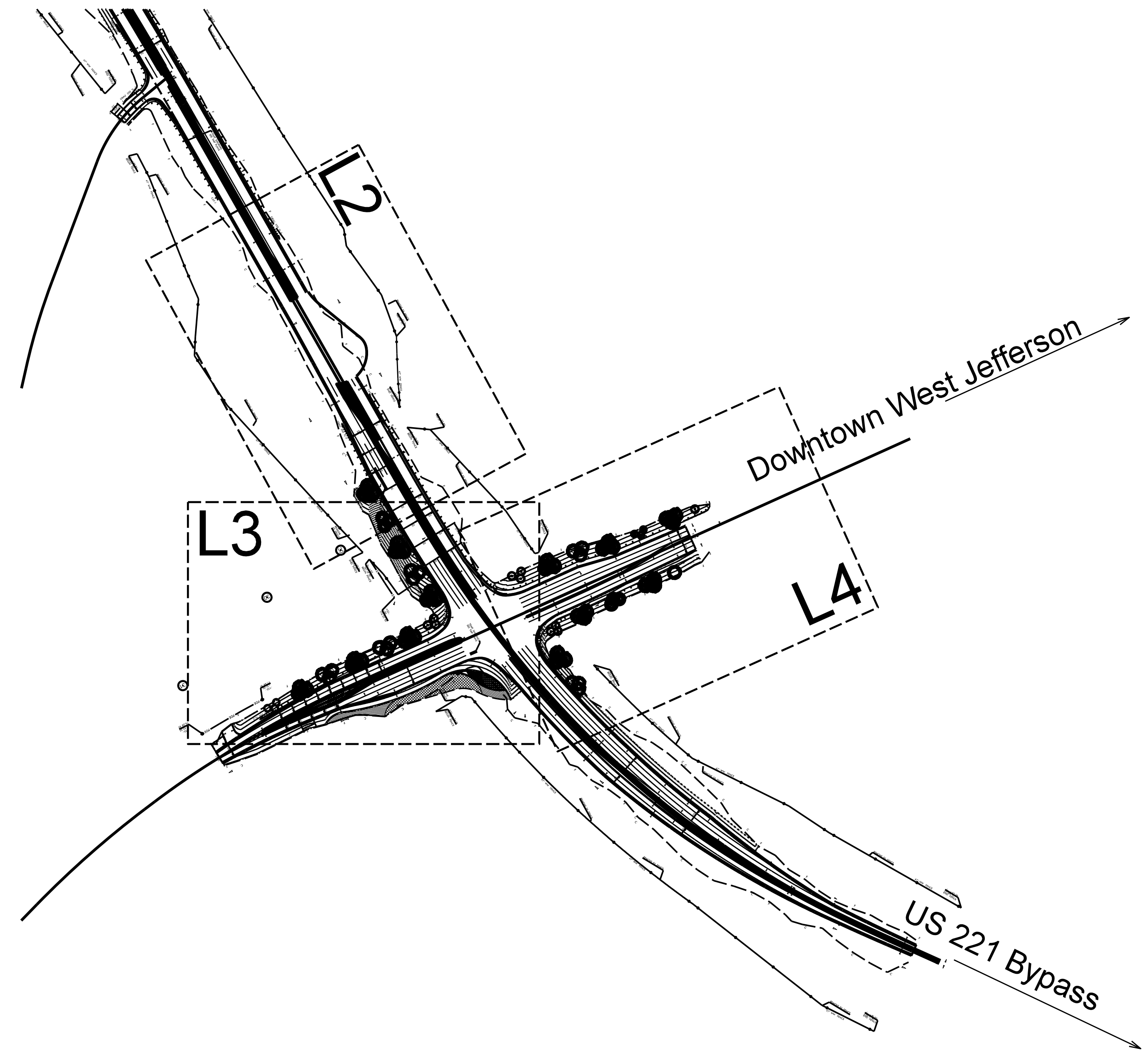

PLANT SYMBOLOLOGY (Turf & Perennials)

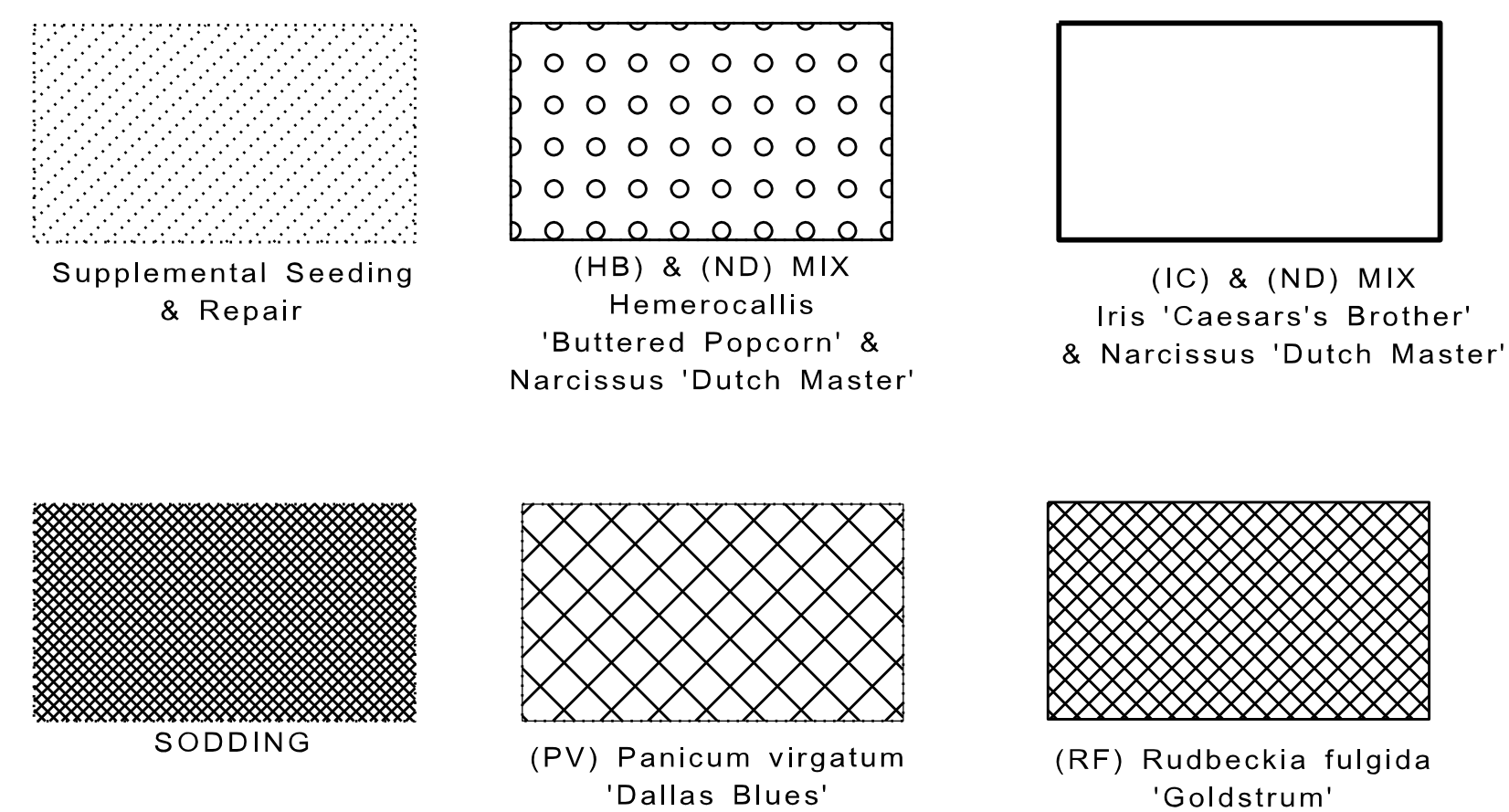

QUANTITY	UNIT	KEY	BOTANICAL NAME	COMMON NAME
Evergreen Trees (LARGE)				
3	EA	PAL	Picea abies	Frasier Fir
Deciduous Trees (LARGE)				
	EA	ABL	Acer rubrum 'Autumn Blaze'	Autumn Blaze Red Maple
	EA	ARL	Acer rubrum 'October Glory'	October Glory Red Maple
	EA	QAL	Quercus alba	White Oak
	EA	QCL	Quercus coccinea	Scarlet Oak
	EA	QSL	Quercus shumardii	Shumard Oak
	EA	TGL		
Shrubs / Native Grass and Perennial Varieties				
	EA	BA	Bouteloua gracilis 'Blonde Ambition' PP22048	Blue Grama Grass
150	EA	HB	Hemerocallis 'Buttered Popcorn'	Buttered Popcorn Daylily
80	EA	IC	Iris 'Caesars's Brother'	Caesars's Brother Bearded Iris
230	EA	ND	Narcissus 'Dutch Master'	Dutch Master Daffodil
	EA	PV	Panicum virgatum 'Cloud Nine	Cloud Nine Switchgrass
120	EA	RF	Rudbeckia fulgida 'Goldstrum'	Black Eyed Susan

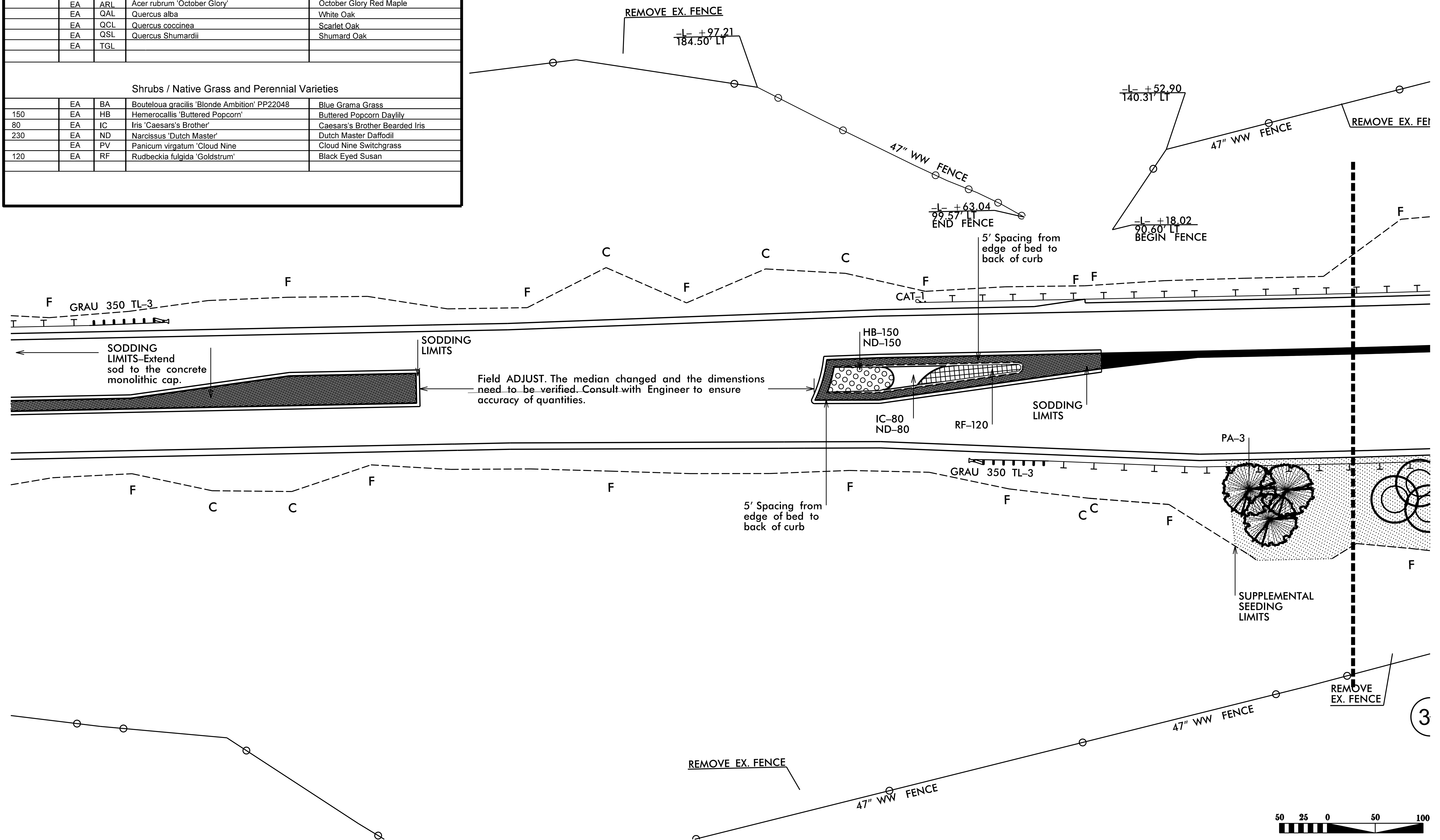

SHEET NO.
L2

PROJECT REF. NO.
R-2915D West Jefferson

US 221 Bypass Corridor Enhancements & Aesthetics
West Jefferson, North Carolina



N.C. Department of Transportation
Roadside Environmental Unit - Design Section
Planting Plan

L2

QUANTITY	UNIT	KEY	BOTANICAL NAME	COMMON NAME
Evergreen Trees (LARGE)				
15	EA	PAL	<i>Picea abies</i>	Frasier Fir
Deciduous Trees (LARGE)				
3	EA	ABL	<i>Acer rubrum</i> 'Autumn Blaze'	Autumn Blaze Red Maple
6	EA	ARL	<i>Acer rubrum</i> 'October Glory'	October Glory Red Maple
	EA	QAL	<i>Quercus alba</i>	White Oak
3	EA	QCL	<i>Quercus coccinea</i>	Scarlet Oak
3	EA	QSL	<i>Quercus shumardii</i>	Shumard Oak
6	EA	TGL		
Shrubs / Native Grass and Perennial Varieties				
1240	EA	BA	<i>Bouteloua gracilis</i> 'Blonde Ambition' PP22048	Blue Grama Grass
440	EA	HB	<i>Hemerocallis</i> 'Buttered Popcorn'	Buttered Popcorn Daylily
115	EA	IC	<i>Iris</i> 'Caesars's Brother'	Caesars's Brother Bearded Iris
555	EA	ND	<i>Narcissus</i> 'Dutch Master'	Dutch Master Daffodil
337	EA	PV	<i>Panicum virgatum</i> 'Cloud Nine'	Cloud Nine Switchgrass
350	EA	RF	<i>Rudbeckia fulgida</i> 'Goldstrum'	Black Eyed Susan

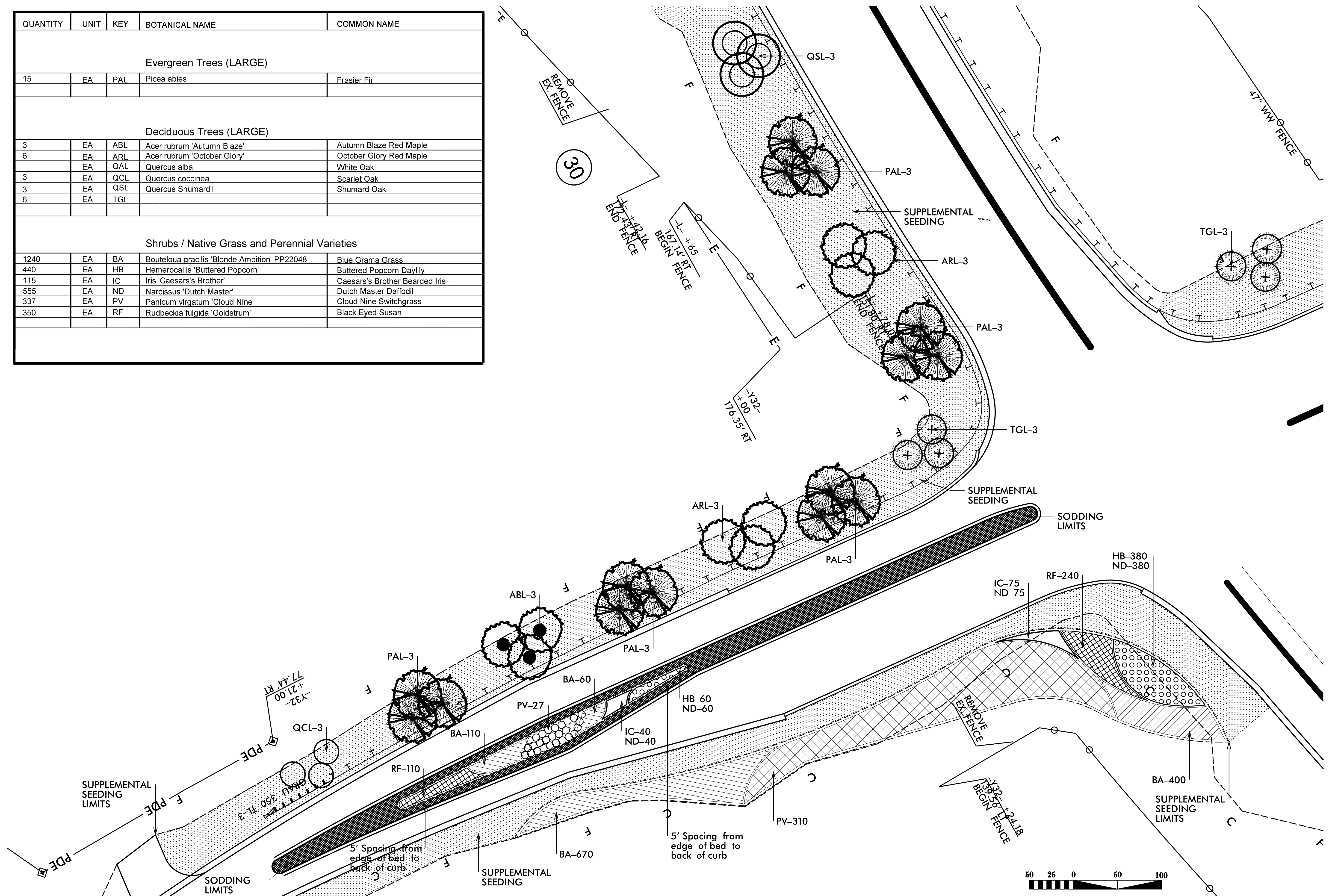

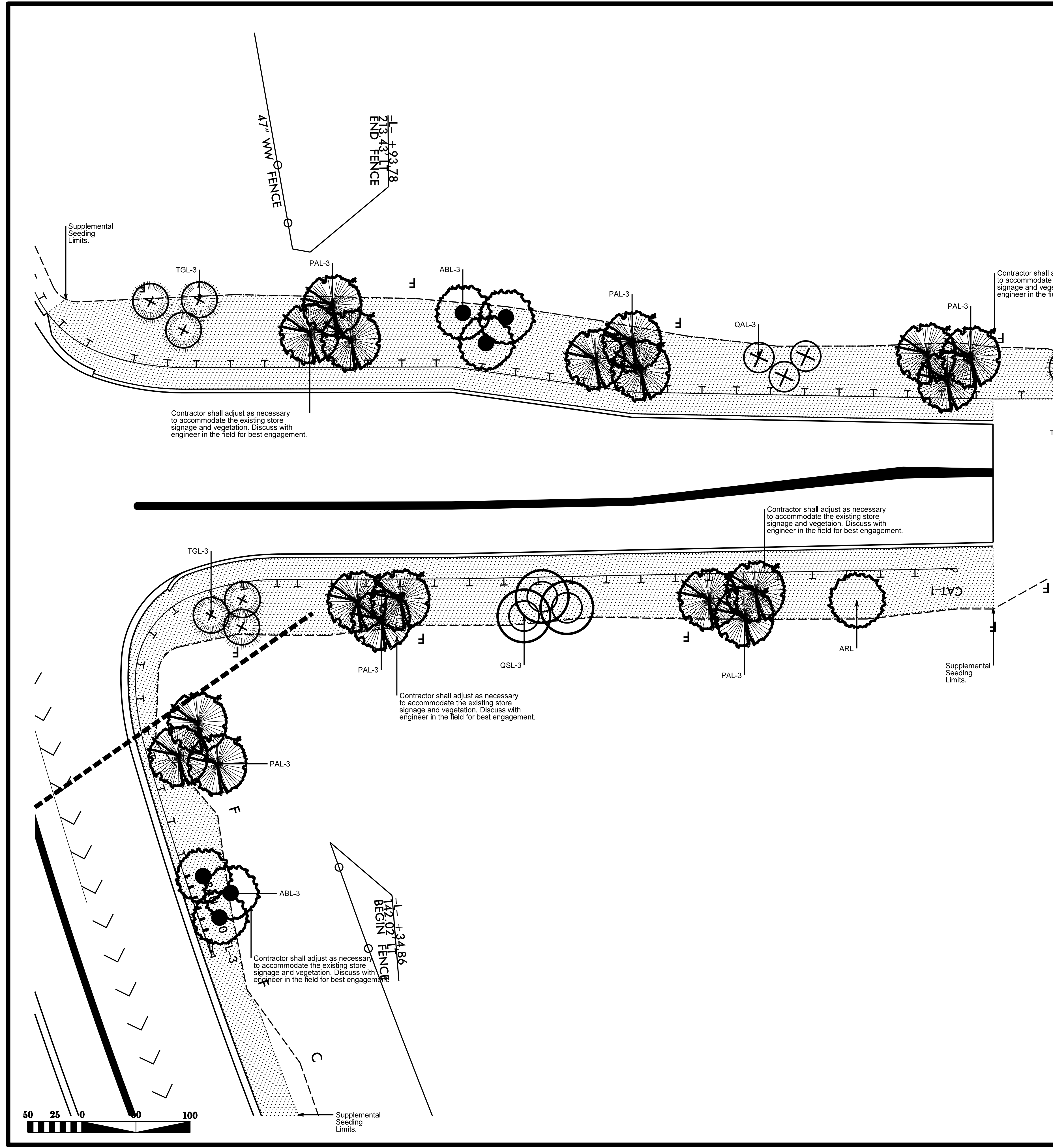
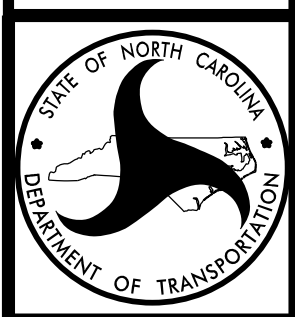

QUANTITY	UNIT	KEY	BOTANICAL NAME	COMMON NAME
Evergreen Trees (LARGE)				
18	EA	PAL	<i>Picea abies</i>	Frasier Fir
Deciduous Trees (LARGE)				
6	EA	ABL	<i>Acer rubrum</i> 'Autumn Blaze'	Autumn Blaze Red Maple
1	EA	ARL	<i>Acer rubrum</i> 'October Glory'	October Glory Red Maple
3	EA	QAL	<i>Quercus alba</i>	White Oak
	EA	QCL	<i>Quercus coccinea</i>	Scarlet Oak
3	EA	QSL	<i>Quercus shumardii</i>	Shumard Oak
7	EA	TGL		
Shrubs / Native Grass and Perennial Varieties				
	EA	BA	<i>Bouteloua gracilis</i> 'Blonde Ambition' PP22048	Blue Grama Grass
	EA	HB	<i>Hemerocallis</i> 'Buttered Popcorn'	Buttered Popcorn Daylily
	EA	IC	<i>Iris</i> 'Caesars's Brother'	Caesars's Brother Bearded Iris
	EA	ND	<i>Narcissus</i> 'Dutch Master'	Dutch Master Daffodil
	EA	PV	<i>Panicum virgatum</i> 'Cloud Nine'	Cloud Nine Switchgrass
	EA	RF	<i>Rudbeckia fulgida</i> 'Goldstrum'	Black Eyed Susan

